



Combined Fire Extinguishant Extract And Pressure Relief Damper

Complies to BS EN 14520: 2006 and 15004: 2008

LPG Fire Australia PTY LTD
1/10 Fremantle Street
Burleigh Heads, QLD 4220
P:0755221953 F: 0755938906
E: info@lpgfire.com.au
W: www.lpgfire.com.au

Typical Layout of Extinguishant Gas Extract & Pressure Relief Damper

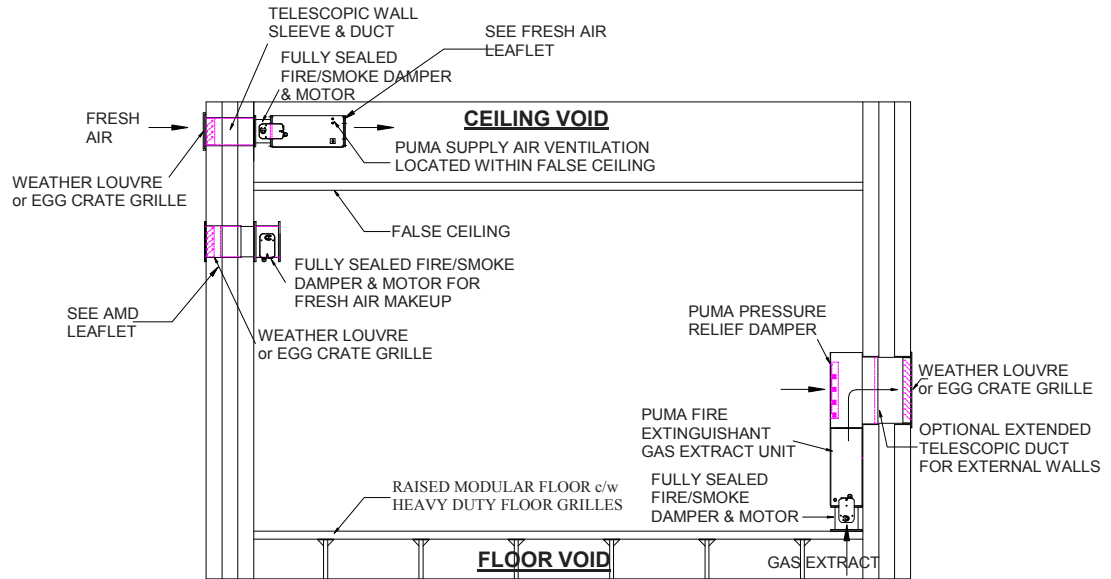

DUAL ACTION & FUNCTION

The Combined Fire Extinguishant Extract Unit and Pressure Relief Damper incorporates the safety aspects of Pressure Integrity, Fire Integrity and Air Integrity.

The combination of an efficient high pressure fan and Fire/Smoke Damper will protect the room and provide effective ventilation post gas discharge.

The precision engineering, proven design and fully tested products, combine to provide dual function, requiring only one wall opening or cut-out.

QUALITY SOLUTIONS

All Combined FE / PRD Units are fitted with a Fire Rated Pressure Relief Damper, Fire/Smoke Damper and 240V actuator, Direct Driven Fan & Motor assembly, Wall Mounting Plenum, Telescopic Duct and External Weather Louvre c/w Bird Screen.

QUALITY FINISH

All products are manufactured from Zintec Steel and polyester powder coated to RAL 9010 - Special colours are available on request



External View Showing Weather Louvre

The PUMA Combined FE / PRD Units provide Free Vent Areas between 0.021 m² and 0.87 m² and Airflows of 0.1 m³/Sec to 2.1 m³/Sec @ 50 Pa External Static Pressure. A full table of the entire range is shown on the reverse page

Rooms or Enclosures utilising Gaseous Extinguishing Systems such as Inergen, Argon and Nitrogen require OVER pressure relief and positive extract in the event of a discharge. The PUMA range of Combined Fire Extinguishant and Pressure Relief Dampers are designed specifically for that purpose.

The TWELVE individual models have been designed by matching the closest Free Vent Area Pressure Relief Damper to the most appropriate Gas Extract Fan Unit. The Fire Smoke Damper and Pressure Relief Damper have been tested by Exova Warrington to BS EN 1634 - 1 2008 - Rated at 2 Hours. All PRD's have Classification to BSEN 13501 E W - 120



Distributed by
LPG Fire Australia
Ph: +61 55221953
www.lpgfire.com.au



Combined Fire Extinguishant Extract And Pressure Relief Damper

Complies to BS EN 14520: 2006 and 15004: 2008

LPG Fire Australia PTY LTD
 1/10 Fremantle Street
 Burleigh Heads, QLD 4220
 P:0755221953 F: 0755938906
 E: info@lpgfire.com.au
 W: www.lpgfire.com.au

Puma™ Products - innovation - design - quality

TECHNICAL SUPPORT

PUMA can offer a wealth of experience in sales, application and technical support
 Using the latest CAD design software we can provide detailed drawings in dxf or pdf formats

- SERVICES AVAILABLE
- Technical Support
- Installation and Setup
- Maintenance
- Application Support
- Fitting Instructions
- 2 Year Warranty

BESPOKE SOLUTIONS

Puma Products operate a continuous design and improvement policy and reserve the right to change designs and specifications without notice

CONTACT DETAILS

For more information on any of our products or services please visit us on the Web at:
 www.pumaproducts.co.uk
 Telephone + 44 (0)1264 333305
 sales@pumaproducts.co.uk



Internal View Showing PRD and FE Unit

Puma Products Limited™ has supported the specific requirements of the Data Hall - Server Room - Electronic Data Processing Environment for over 30 years. Located in the South of England, we at Puma are widely recognized as experts in the field of air movement. Our knowledge and expertise have developed many products - such as Fresh Air Supply and Fire Extinguishant Gas Extract Systems, incorporating Fire/Smoke Dampers. In 1984 we developed the first bespoke range of Fire Extinguishant Gas Extract Units, then in 1999 we developed the first Fire Rated Pressure Relief Dampers to relieve the 'Pulse' pressure spike on the release of high pressure Inert Gas Systems - The advent of sealed rooms and integrity testing created the need for the **COMBINED FIRE EXTINGUISHANT GAS EXTRACT and PRESSURE RELIEF DAMPER**

Twelve Models Available refer to Technical Data Sheet for Wall Cut-out sizes etc.

Model Number	Airflow @ 50 PA m³/s	Running Current @ 230 V ac 1PH 50Hz	Weight Kg	Free Vent Area m²	Dimensions in mm		
					D	W	H
FE 250 S MK3 - PRD 150	0.1	0.46 A	15	0.02	154	340	850
FE 350 S MK3 - PRD 225	0.140	0.77 A	17	0.04	154	385	895
FE 250/400 - PRD 300	0.2	0.8 A	36	0.079	250	500	1160
FE 250/600 - PRD 375	0.26	1.2 A	38	0.124	250	535	1195
FE 300/700 - PRD 450	0.34	1.49 A	42	0.178	300	610	1370
FE 300/1400 - PRD 525	0.64	7.6 A	45	0.252	300	685	1445
FE 350/850 - PRD 600	0.4	1.9 A	60	0.317	350	760	1620
FE 350/1000 - PRD 675	0.48	2.3 A	65	0.42	350	835	1695
FE 400/1800 - PRD 750	0.78	4.2 A	80	0.515	415	910	1770
FE 450/2500 - PRD 825	1.2	6.8 A	95	0.622	450	985	1845
FE 550/3600 - PRD 900	1.72	4.3 A**	130	0.713	550	1060	2120
FE 550/4500 - PRD 975	2.05	4.6 A**	135	0.87	550	1135	2195



Distributed by
LPG Fire Australia
 Ph: +61 55221953
 www.lpgfire.com.au